

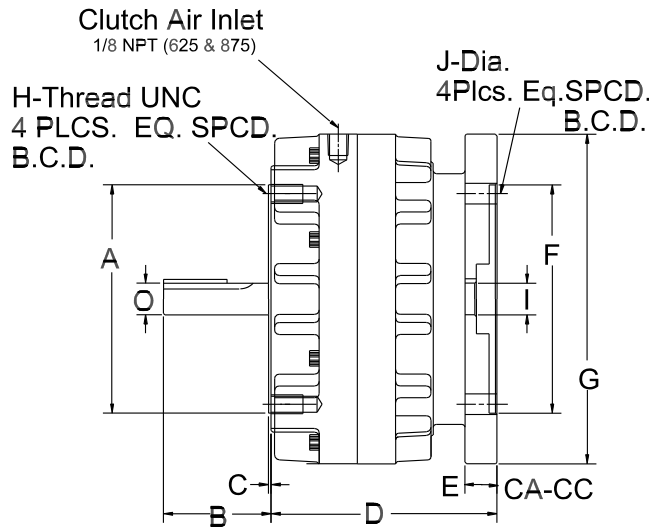

MODEL CA-CC CLUTCH



Dimensions shown are for general information only.
Certified prints will be furnished upon request for design and installation purposes.

MODEL	TORQUE** (IN-LB)	STATIC	DYNAMIC	HEAT DISSIPATION	HEAT CAPACITY	WK ² OF CYCLING PARTS	MAXIMUM RPM ALL UNITS	REPAIR KIT
625 & 875 AIR CLUTCH	@ 80 PSI	375	300	.09 HP	20,000 FT-LB	1.1 IN ² -LB	1800	2869K(A)

STANDARD ASSEMBLIES	A	B	C	D	E	F	G	H	J	I (inches)	O (inches)	B.C.D.	INPUT SHAFT OHL*	OUTPUT SHAFT OHL*	NEMA FRAMES
625CA-CC	4.499	2 1/16	1/8	3 7/8	5/8	4.501	6 ½	3/8-16	13/32	.626	.625	5.875	0	0	48Y/56C
875CA-CC	4.499	2 1/8	1/8	3 7/8	5/8	4.501	6 ½	3/8-16	13/32	.876	.875	5.875	0	0	143TC/145TC

*Based on 10,000 hours bearing life with load 1 inch from bearing face.

**The initial torque on some units may be up to 40% less than torque values shown until the friction lining is worn in.

THE CARLSON CO. INC. USA

Fax: (316) 744-2144 • Phone: (316) 744-0481
www.carlsoncompany.com

2008

A - 5

Lubricated Air Required