

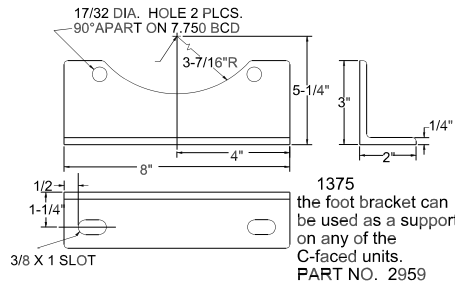

# MODEL CAB-CC and CAB-SS CLUTCH/BRAKE

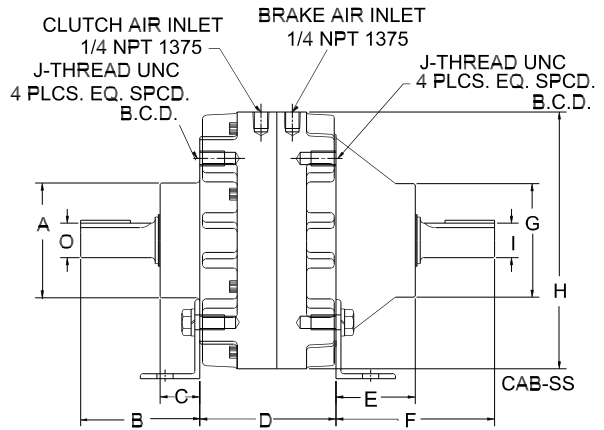
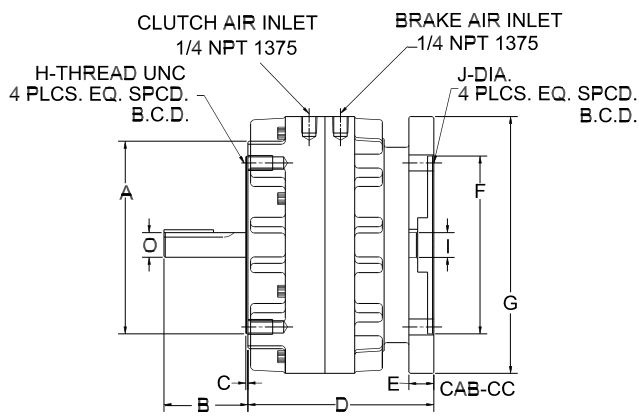

DIMENSIONS SHOWN ARE FOR GENERAL INFORMATION ONLY  
CERTIFIED PRINTS WILL BE FURNISHED UPON REQUEST FOR DESIGN AND INSTALLATION PURPOSES.

MODEL	TORQUE** (IN-LB)	STATIC	DYNAMIC	HEAT DISSIPATION	HEAT CAPACITY	WK <sup>2</sup> OF CYCLING PARTS	MAXIMUM RPM ALL UNITS 1800
1375 AIR CLUTCH/AIR BRAKE	CLUTCH@80psi BRAKE@80psi	960 1400	800 1180	.44HP (50%CLUTCH 50% BRAKE)	60,000 FT-LB	16 IN <sup>2</sup> -LB	

STANDARD ASSEMBLIES	A	B	C	D	E	F	G	H	J	BCD	I (INCHES)	O (INCHES)	INPUT SHAFT OHL*	OUTPUT SHAFT OHL*	NEMA FRAMES
1375CAB-CC	8.498	3.125	1/4	6.000	1/2	8.502	9.000	1/2-13	17/32	7.250	1.376	1.376	0	0	213TC/215TC
1375 CAB-SS	4	4 3/4	1 5/8	4 3/4	2 11/16	5 13/16	4 1/4	9.000	1/2-13	7.750	1.375	1.375	275#	275#	NA

\*Based on 10,000 hours bearing life with load 1 inch from face of bearing.

\*\*The initial torque on new units may be up to 40% less than torque values shown until the friction lining is worn in.

CAB REPAIR KITS	
MODEL	PART NUMBER
1375 CAB-CC	2961K
1375 CAB-SS	2966K

THE CARLSON CO. INC. USA

Fax: (316) 744-2144 • Phone: (316) 744-0481

www.carlsoncompany.com

2008

A - 4

Lubricated Air Required