

# SB SHOE BRAKE MODELS

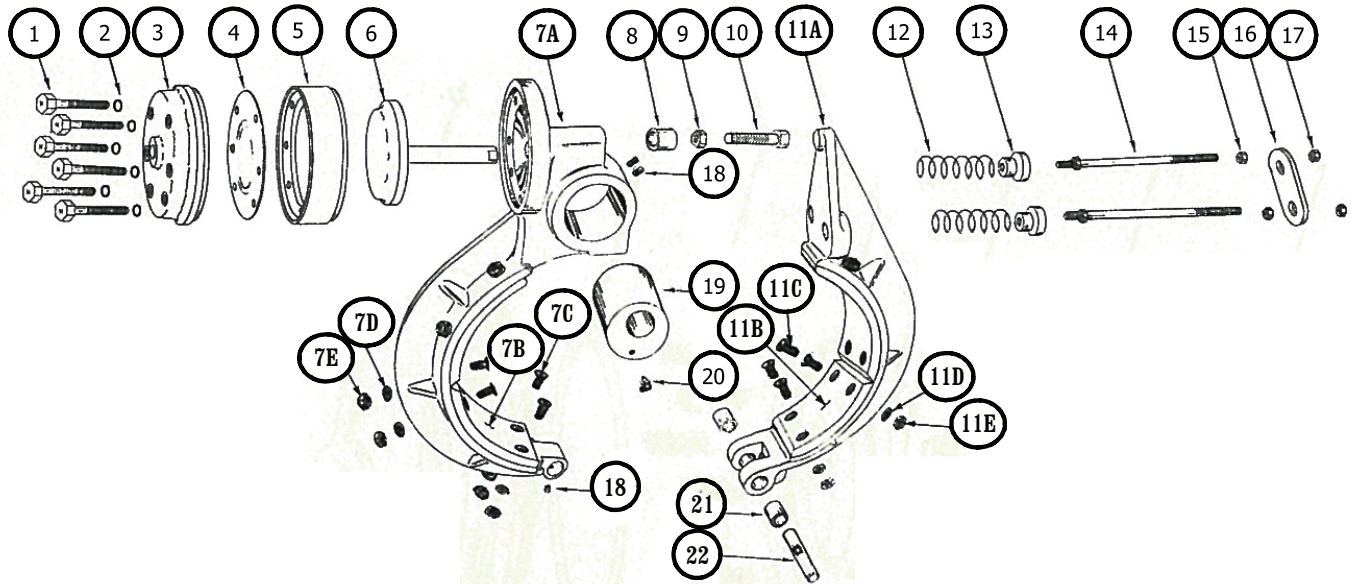

MODEL		7SB 3012		10SB 3016		14SB 4009	
ITEM	DESCRIPTION	PART NO.	Qty.	PART NO.	Qty.	PART NO.	Qty.
1.	Cap Screws	1122-6	6	1122-7	6	1122-7	6
2.	Lockwashers	1019-4	6	1019-4	6	1019-4	6
3.	Cap	2635	1	2351	1	2351	1
4.	Diaphragm	2636	1	2354	1	2354	1
5.	Spacer	2637	1	2352	1	2352	1
6.	Piston Rod Assy.	2638	1	2761	1	2353	1
7.	Primary Shoe Assy.	2384	1	2388	1	2392	1
7A.	Primary Shoe	2386	1	2390	1	2394	1
7B.	Friction Lining	2825-1	2	2825-2	2	2825-3	2
7C.	Screws	2830	8	2831-1	8	2831-2	8
7D.	Lockwashers	1019-1	8	1019-4	8	1019-4	8
7E.	Nuts	1510-0	8	1510-1	8	1510-1	8
8.	Piston Rod Bushing	1132	1	1132	1	1132	1
9.	Jam Nut	1118-5	1	1118-5	1	1118-5	1
10.	Push Rod	1120	1	1120	1	1120	1
11.	Secondary Shoe Assy.	2385	1	2389	1	2393	1
11A.	Secondary Shoe	2387	1	2391	1	2395	1
11B.	Friction Lining	2825-1	2	2825-2	2	2825-3	2
11C.	Screws	2830	8	2831-1	8	2831-2	8
11D.	Lockwashers	1019-1	8	1019-4	8	1019-4	8
11E.	Nuts	1510-0	8	1510-1	8	1510-1	8
12.	Spring	1146	2	1146	2	1146	2
13.	Spring Washer	1145	2	1615	2	1615	2
14.	Spring Stud	1144	2	1617	2	1617	2
15.	Spring Adjustment Nut	1088-3	2	1088-5	2	1088-5	2
16.	Spacer Bracket	1369	1	1370	1	1370	1
17.	Jam Nut	1118-5	2	1118-7	2	1118-7	2
18.	Set Screw	1108-3	3	1108-3	3	1108-3	3
19.	Eccentric Bushing	1138	1	1123	1	1514	1
20.	Grease Fitting	1434-1	1	1434-1	1	1434-1	1
21.	Pivot Bushing	1141	2	1126	2	1515	2
22.	Pivot Pin	1142-1	1	1127-1	1	1516-1	1

**THE CARLSON COMPANY, INC.**

PHONE: (316) 744-0481

FAX: (316) 744-2144

6045 NORTH BROADWAY

E-MAIL: sales@carlsoncompany.com

WICHITA, KANSAS 67219

USA

WEB: www.carlsoncompany.com