

MODEL 6UC PM

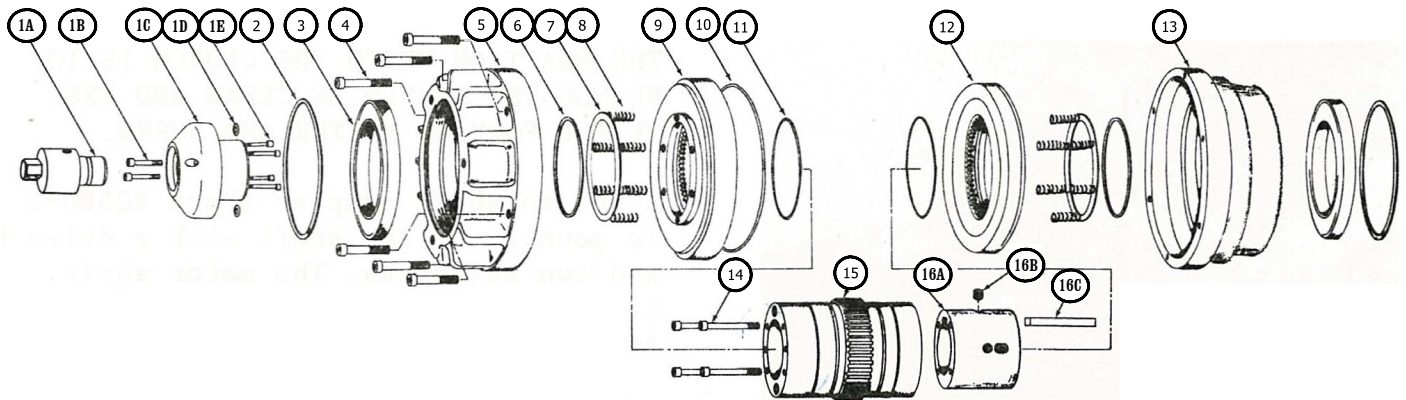

ITEM	NAME	PART NO.	Qty
1.	Air Supply Accessory Kit	* 2341	1
1A.	Rotating Air Union	2234	1
1B.	Socket Head Cap Screw(Air Union Adapter)	1656-7	2
1C.	Air Union Adapter	2338	1
1D.	O-Ring (Adapter to Hub Seal)	2339	2
1E.	Socket Head Cap Screw (Air Union)	2125-10	4
2.	Retaining Ring(Bearing Outer Race)	2509	2
3.	Bearing	2508	2
4.	Socket Head Cap Screw(Pressure Plate)	1666-8	6
5.	Pressure Plate	2512-01	1
6.	Retaining Ring(Bearing Inner Race)	2507	2
7.	Spacer	2502	2
8.	Return Spring	2503	12
9.	Outer Torque Plate Assembly	2521-1	1
9A.	Outer Torque Plate	2522-1	1
9B.	Friction Lining	2517-1	1
10.	O-Ring (Torque Plate Rim)	2504	1
11.	O-Ring (Torque Plate Hub)	2510	2
12.	Inner Torque Plate Assembly	2519-1	1
12A.	Inner Torque Plate	2520-1	1
12B.	Friction Lining	2517-1	1
13.	Backplate, Pilot Mount	2582	1
14.	Socket Head Cap Screw(Hub to Adapter)	1666-13	4
15.	Hub	2523	1
16.	Hub to Shaft Adapter Assembly	** 2580-	1
16A.	Hub to Shaft Adapter	1248-	1
16B.	Set Screw	1394-2	2
16C.	Key	2581-	1

* Air Supply Accessory Kit NOT included in clutch assembly.

It must be ordered separately.

** Hub to Shaft Adapter Assembly is NOT included in clutch assembly.

It must be ordered separately with bore and keyway size specified.

THE CARLSON COMPANY, INC.

6045 NORTH BROADWAY

WICHITA, KANSAS 67219

USA

PHONE: (316) 744-0481

FAX: (316) 744-2144

E-MAIL: sales@carlsoncompany.com

WEB: www.carlsoncompany.com